

REFER TO CREEKLAND DESIGN GUIDELINES FOR STANDARD FENCING DETAILS.

NOTE: IF MORE THAN 30' OF WOOD FENCE IS EXPOSED, IT WILL REQUIRE A 3' PLANTING BUFFER ON THE STREET SIDE AND (2) TREE PER 30' OF EXPOSED FENCE (30 GAL. ORNAMENTAL TREE).

NOTE: QUANTITIES PROVIDED ON THIS SHEET ARE APPROXIMATE AND FOR USE IN TAKEOFF PURPOSES ONLY. REFER TO FENCE CONSTRUCTION DETAILS FOR PRECISE FENCE LAYOUT IN RELATION TO STAKED LOT CORNERS AND R.O.W.

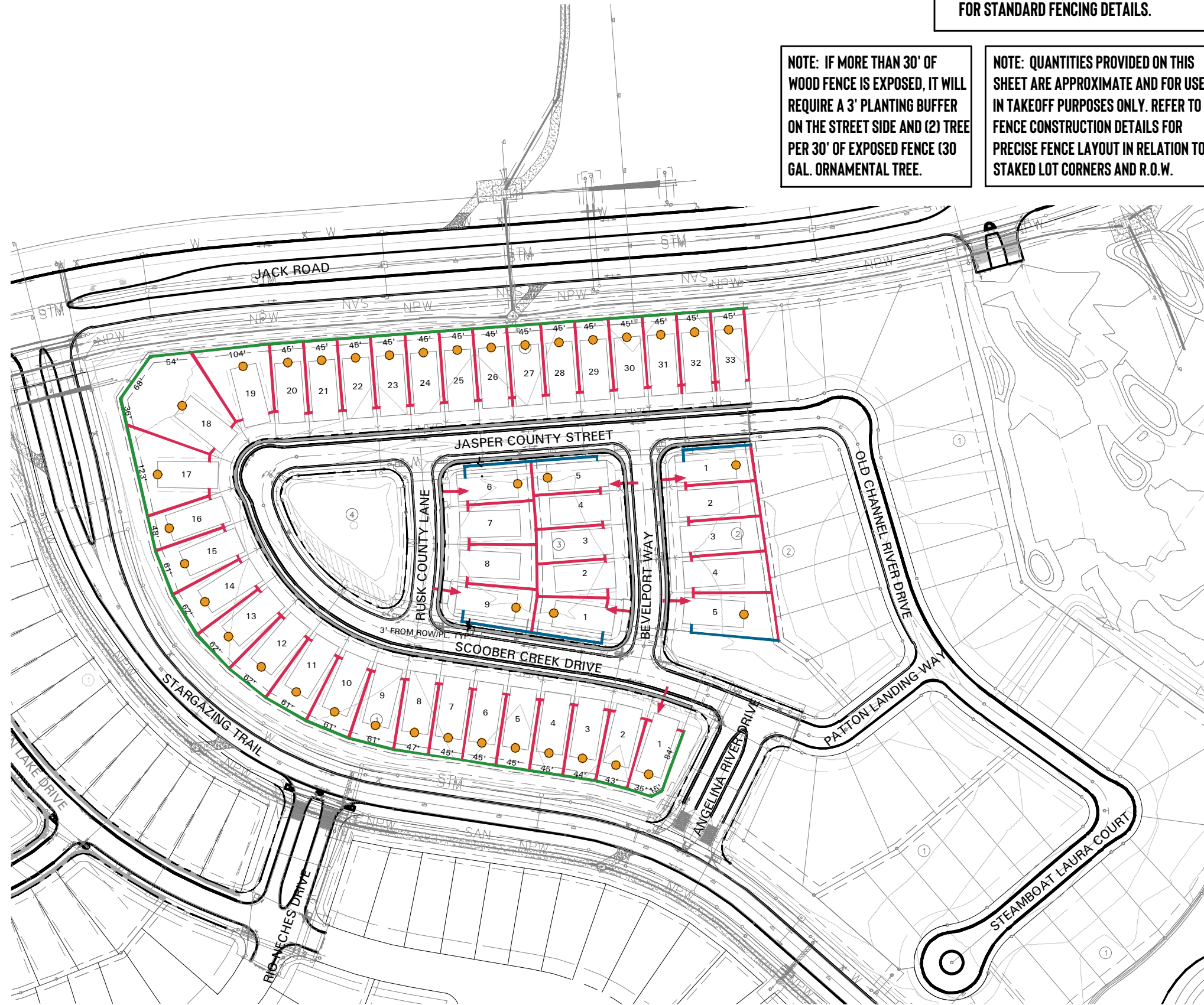
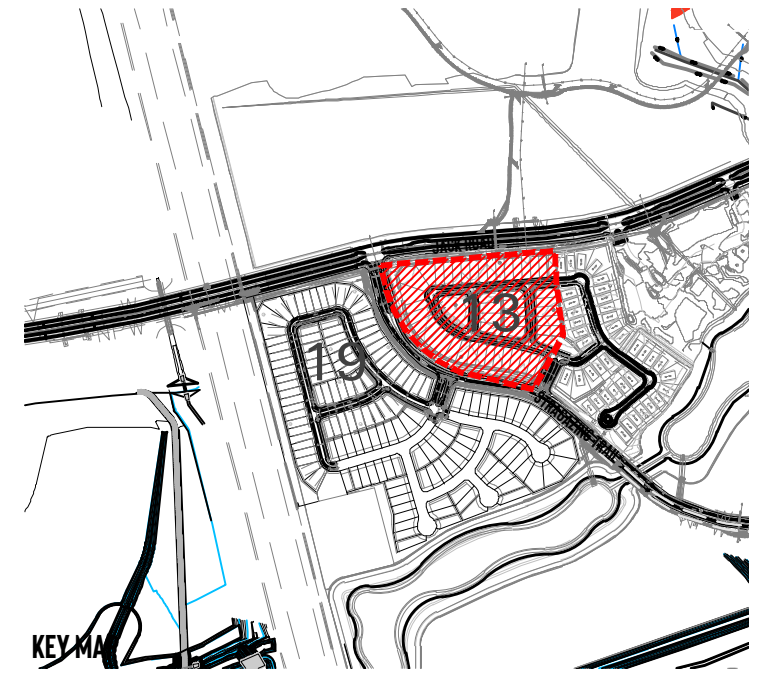

- DRIVEWAY LOCATION VERIFIED BY ENGINEER
- PRELIMINARY PLAT
- FINAL PLAT
- RECORDED PLAT

**FENCING LEGEND**

- 6 FT. HIGH SINGLE WYTHE BRICK BY DEVELOPER
- 8 FT. HIGH SINGLE WYTHE BRICK BY DEVELOPER
- 6 FT. FENCECRETE BY DEVELOPER
- 5 FT. HIGH TUBE STEEL BY BUILDER
- 6 FT. HIGH DOUBLE-SIDED WOOD BY BUILDER
-  45° CORNER CLIP, 10'x10' OFFSET REF. DESIGN GUIDELINE EXHIBIT D7, "CORNER LOT FENCE REQUIREMENT - OPEN TUBE STEEL"
- DRIVEWAY LOCATION
- MASONRY REQUIRED ON SECOND STORY; REFERENCE RESIDENTIAL DEVELOPMENT STANDARDS
- - - 3 FT. WIDE EVERGREEN SHRUB PLANTING BUFFER, REF. RESIDENTIAL DEVELOPMENT STANDARDS FOR SPECIES SELECTION
- 5 FT. WIDE BUILDER SIDEWALK
- - - RIGHT OF WAY

Date  
09/30/2025

